

NOTES

DECK 10
Water Storage continues on this deck.

The corridor at the front is one of two that lead to the Command Module. The other corridor is on Deck 7.

Officers' Quarters and Crew Quarters are on this deck.

The Main Engineering Highbay is at the rear of this deck. Ahead of Engineering are more Batteries.

To port and starboard - and slightly forward - of the highbay are the Inspection Corridors leading to the Matter-Antimatter Reaction Chambers which are buried inside each Warp Engine. These corridors start on Deck 11 and continue up to Deck 9.

ENGINE OUTLINE
AT DECK 10

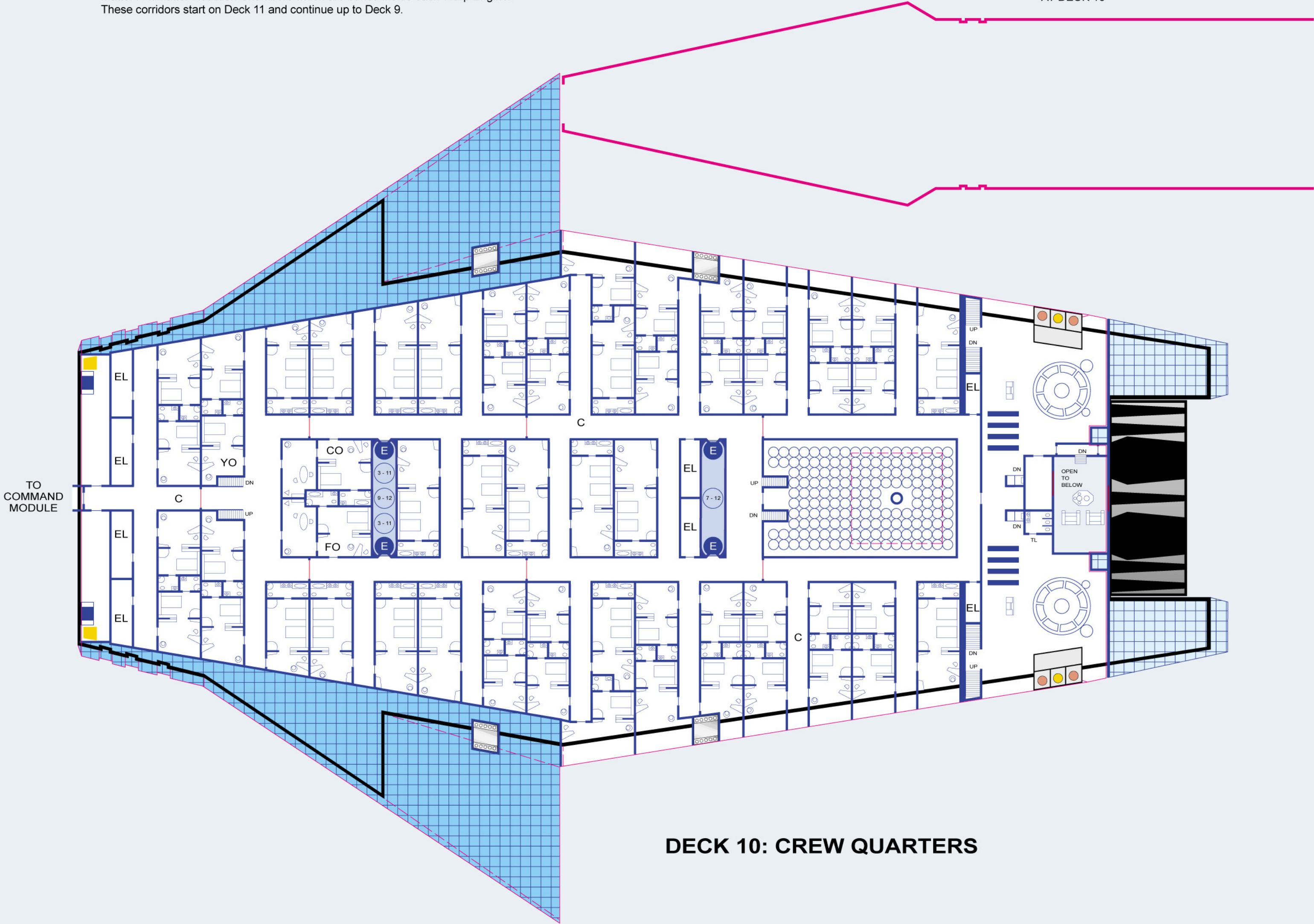

DECK 10: CREW QUARTERS